



91 Kingsclear Road ALEXANDRIA NSW

2 1 1

An outstanding opportunity to renovate or redevelop (STCA), this classic brick semi-detached home located in one of Alexandrias most sought after locales.

A 215 square metre level block with 5.13 metre frontage and 6.96 metres wide at the blocks rear. The property is both rear lane access and a pedestrian lane on the freestanding side, perfect for renovations.

Currently comprising of two spacious bedrooms, living room, large eat in kitchen, laundry and bathroom with separate bath.

The large leafy backyard houses the garage with access from the rear lane. Potential to rebuild as a double garage

Type : House
Land Size : 215 sqm
View : <https://www.trueproperty.com.au/sale/nsw/eastern-suburbs/alexandria/residential/house/7682440>

[For full version visit the website](https://www.trueproperty.com.au/sale/nsw/eastern-suburbs/alexandria/residential/house/7682440)

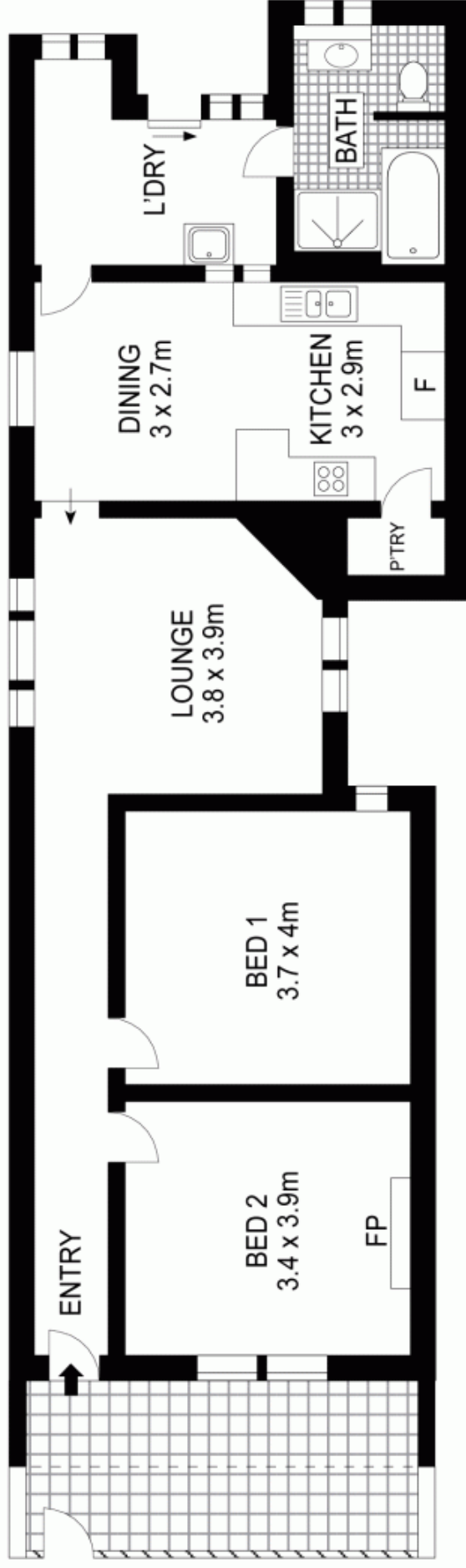

GROUND FLOOR

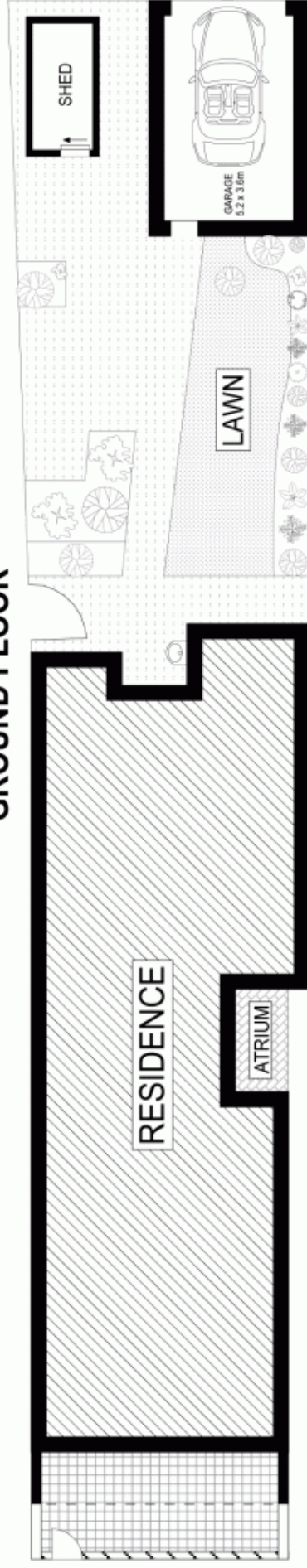

SITE PLAN (NOT TO SCALE)



91 Kingsclear Road, Alexandria