



28 Eton Street CAMPERDOWN NSW

1 1 1

A fabulous first home or investment opportunity in a popular location just moments from everything this area has to offer. This freestanding property offers rear lane access for parking and a large north facing deck, perfect for entertaining.

Type : House
Land Size : 127 sqm
View : <https://www.trueproperty.com.au/sale/nsw/inner-west/camperdown/residential/house/7682420>

Large bedroom with built in robes and air conditioning

Separate living room, polished timber floors

Renovated gas kitchen with Smeg appliances

Bathroom with bath, separate laundry, 127sqm block

Fantastic north facing rear yard with entertainers deck

[For full version visit the website](#)

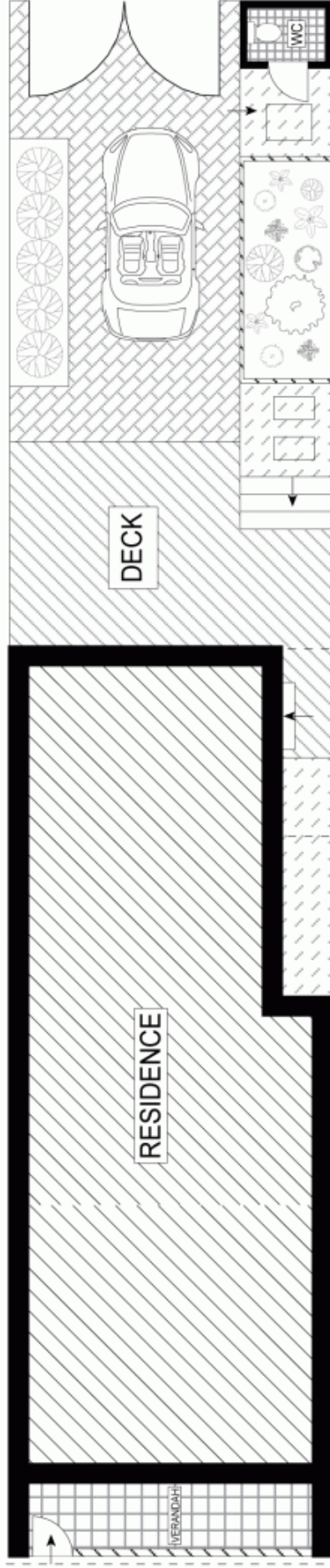

SITE PLAN (NOT TO SCALE)

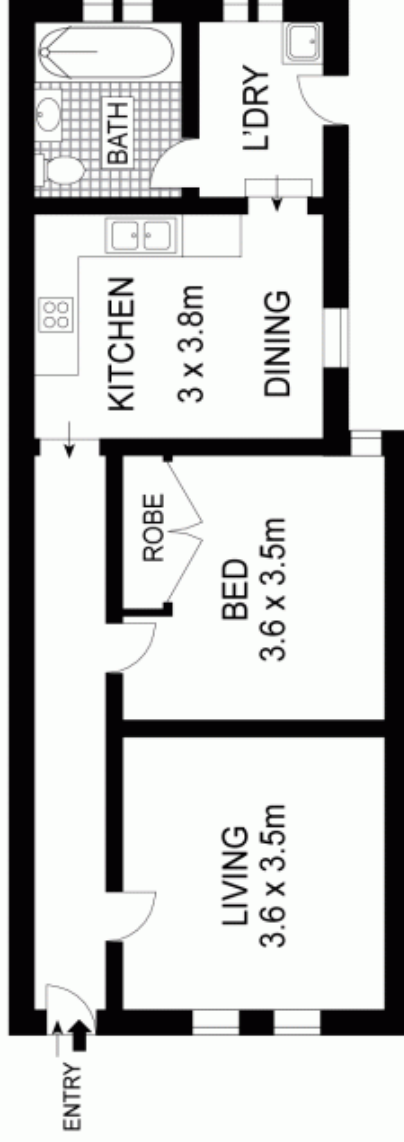

GROUND FLOOR



Scale in metres. Indicative only. Dimensions are approximate. All information contained herein is gathered from sources we believe to be reliable. However, we cannot guarantee its accuracy and interested persons should rely on their own enquiries.

