

31 Devine Street ERSKINEVILLE NSW

2 1

A creative interior redesign has transformed this classic terrace and made it a sleek contemporary residence with lots of natural light and cool modern style throughout. Focusing on enhancing space and privacy, it offers a very sophisticated home embracing low maintenance living and easycare in/outdoor entertaining. This peaceful pocket of Erskineville offers excellent lifestyle convenience with trains, Sydney Park, village cafe's and King Street dining all within easy strolling distance.

Type : House

View : <https://www.trueproperty.com.au/sale/nsw/inner-west/erskineville/residential/house/7682411>

Fresh interiors feature separate living & dining areas
Bi-fold opening doors leading to a private courtyard with custom bench seating
New full sized kitchen includes stone benches & gas fittings
Upstairs bedrooms both have mirrored built-ins

[For full version visit the website](#)

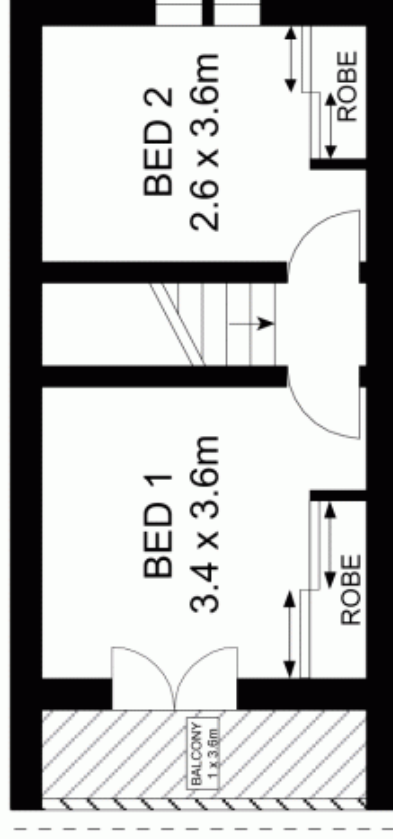

FIRST FLOOR

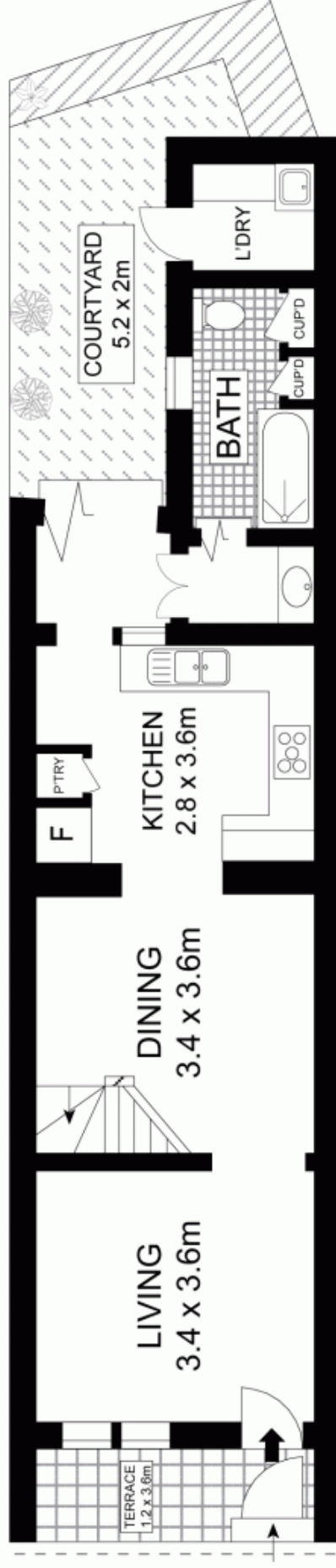

GROUND FLOOR



Scale in metres. Indicative only. Dimensions are approximate. All information contained herein is gathered from sources we believe to be reliable. However, we cannot guarantee its accuracy and interested persons should rely on their own enquiries.

true PROPERTY

31 Devine Street, Erskineville