



## 118/23 Corunna Road STANMORE NSW

1 1 1

Located in the sought after Chocolate Factory this one bedroom apartment is a wonderful home or investment opportunity. Moments from all the areas lifestyle amenities and transport links.

**Type** : Apartment

**View** : <https://www.trueproperty.com.au/sale/nsw/inner-west/stanmore/residential/apartment/7682388>

- Double bedroom with built in wardrobes
- Gas kitchen with granite bench tops, stainless steel appliances and plenty of storage
- Open plan living and dining leads to covered balcony
- Spacious bathroom with bath and separate internal laundry
- Air conditioning, secure parking, intercom with lift access
- Walk to Annandale Village cafes and restaurants
- Nearby Sydney University, UTS and RPA Hospital
- Currently rented for \$470 per week, which makes this an

[For full version visit the website](#)

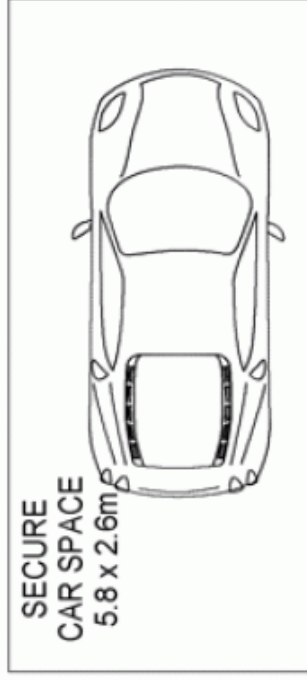

## BASEMENT

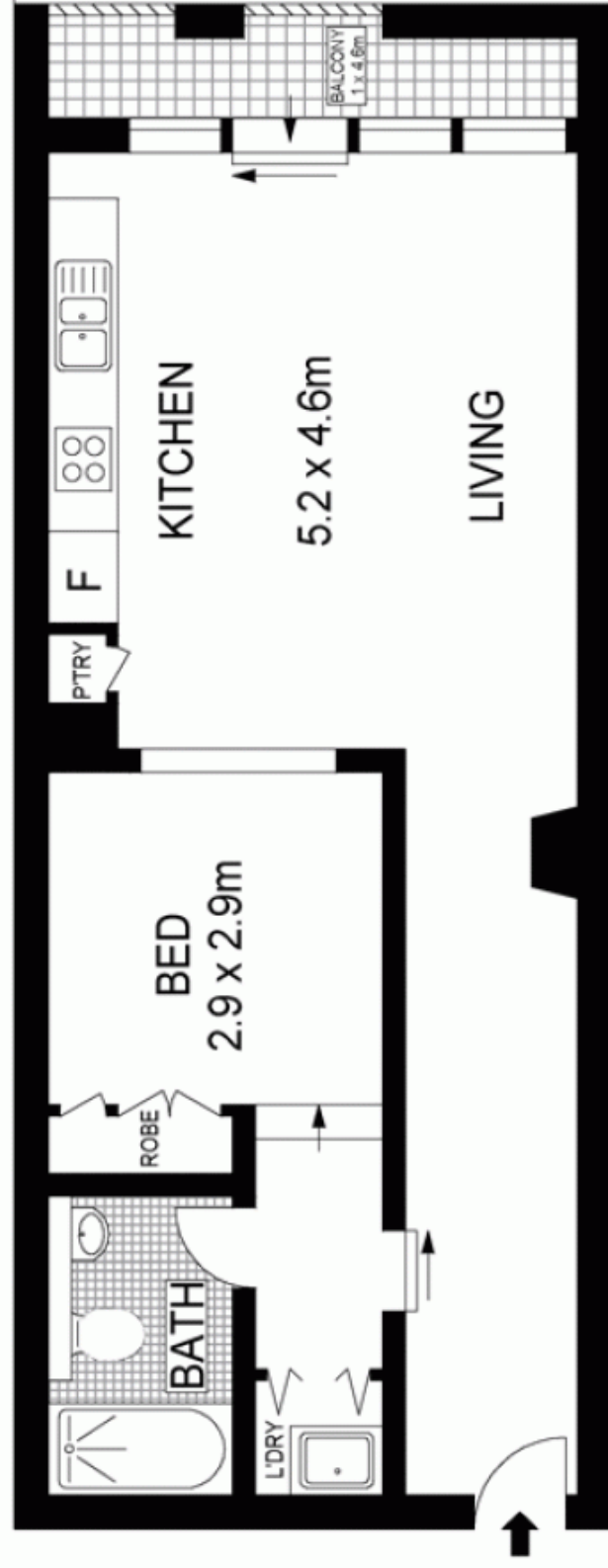

## GROUND FLOOR



Scale in metres. Indicative only. Dimensions are approximate. All information contained herein is gathered from sources we believe to be reliable. However we cannot guarantee its accuracy and interested persons should rely on their own enquiries.



**true** =  
PROPERTY

118/23 Corunna Road, Stanmore