



17/14-18 Ross Street FOREST LODGE NSW

1

Conveniently located only a short stroll from Sydney University, Broadway Shopping Centre and iconic Glebe Point Road, this elevated ground floor studio apartment is perfect for any investor or first home buyer wishing to enter Sydney's Inner West property market.

- = Affordable light filled north/east facing studio apartment
- = Separate timber kitchen with ample storage space
- = One large tiled bathroom and communal laundry
- = Timber flooring and has been recently painted throughout
- = Rental potential approx. \$20,000 per annum
- = Company title building

Type : Apartment
Building Size : 3 sqm
View : <https://www.trueproperty.com.au/sale/inner-west/forest-lodge/residential/apartment/7682295>



Michael Catalano
02 8507 2444

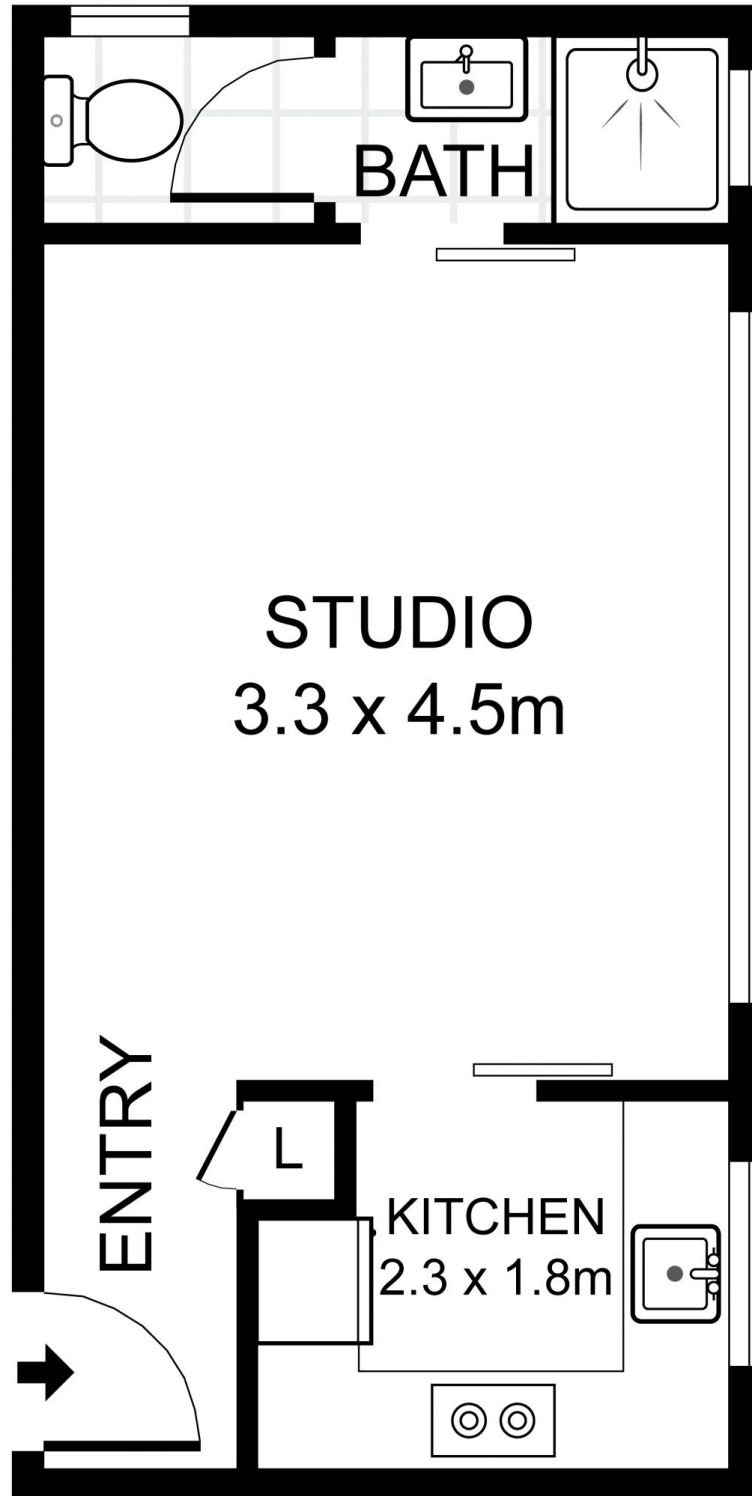

true =
P R O P E R T Y

17/14-18 Ross Street, Forest Lodge

DISCLAIMER: PLANS SHOWN ARE FOR PRESENTATION PURPOSES AND ARE NOT PART OF ANY LEGAL DOCUMENT. ALL MEASUREMENTS AND FIGURES ARE APPROXIMATE.