



## 803/148 Elizabeth Street Sydney NSW

1 1

This unbelievably spacious studio apartment is located in the heart of the CBD with amazing views of the city skyline. Moments to Museum train station, Hyde Park and all that the CBD has to offer.

- = Stylish kitchen with gas cooking and plenty of storage
- = Updated tiled bathroom
- = Located on the eighth floor with lift access
- = 24 hour onsite concierge
- = Huge entertainer's covered balcony

**Type** : Apartment  
**Land Size** : 45 sqm  
**View** : <https://www.trueproperty.com.au/sale/nsw/sydney-city/sydney/residential/apartment/7682138>



**Michael Catalano**  
 02 8507 2444

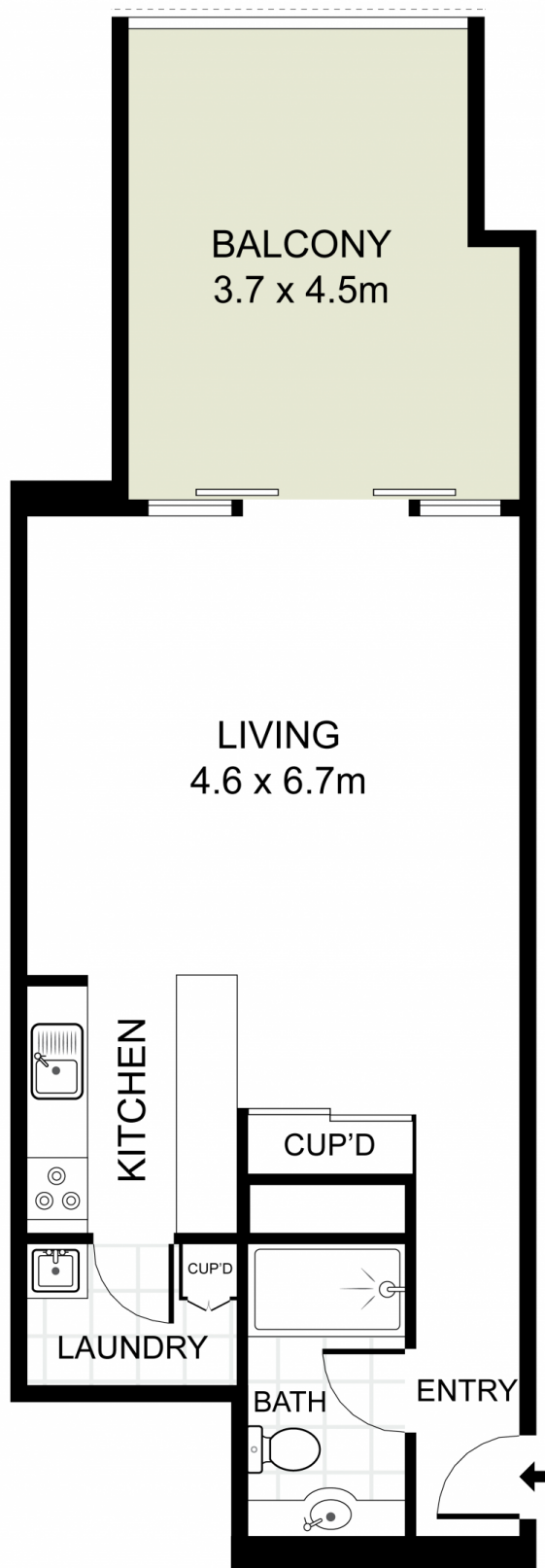

true =  
PROPERTY

803/148 Elizabeth Street, Sydney

DISCLAIMER: PLANS SHOWN ARE FOR PRESENTATION PURPOSES AND ARE NOT PART OF ANY LEGAL DOCUMENT. ALL MEASUREMENTS AND FIGURES ARE APPROXIMATE.

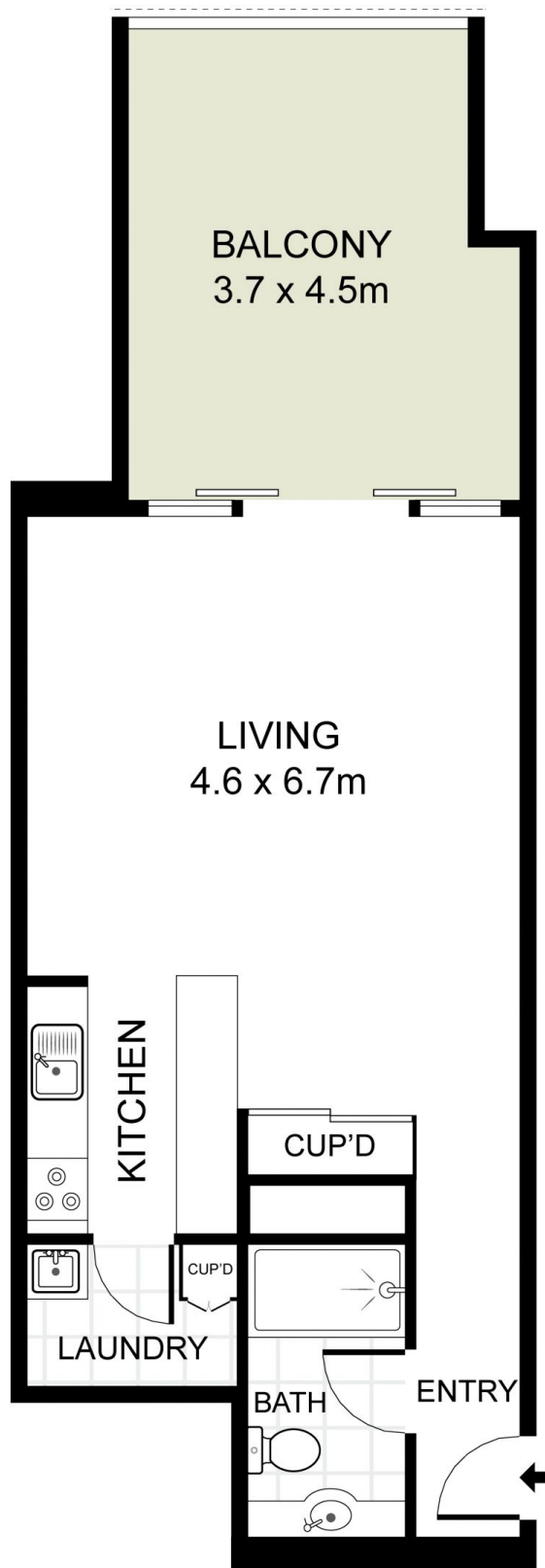

true =  
PROPERTY

803/148 Elizabeth Street, Sydney

DISCLAIMER: PLANS SHOWN ARE FOR PRESENTATION PURPOSES AND ARE NOT PART OF ANY LEGAL DOCUMENT. ALL MEASUREMENTS AND FIGURES ARE APPROXIMATE.